

# WAECO

by Dometic GROUP

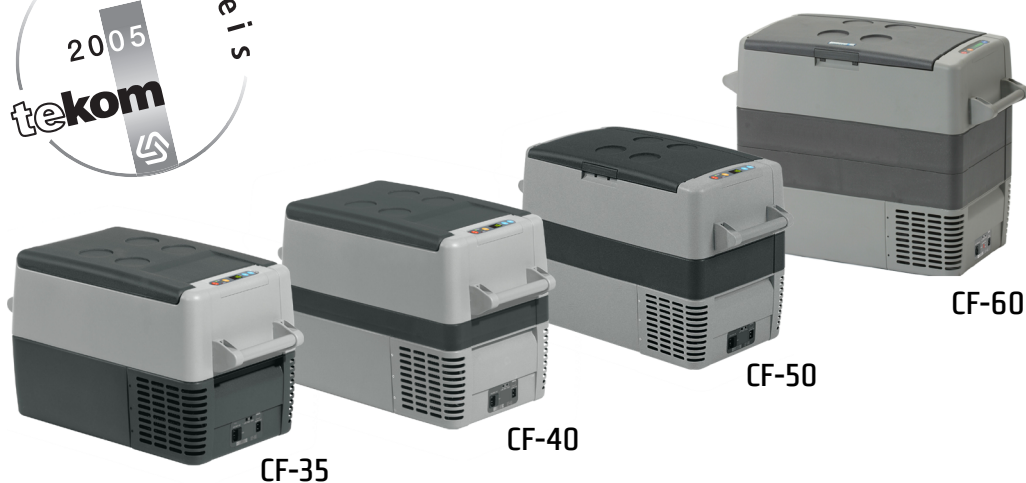

## WAECO CoolFreeze CF-35, CF-40, CF-50, CF-60

DE	6	<b>Kompressor-Kühlbox</b> Bedienungsanleitung
EN	25	<b>Compressor Cooler</b> Instruction Manual
FR	42	<b>Glacière à compression</b> Manuel d'utilisation
ES	61	<b>Nevera por compresor</b> Instrucciones de uso
IT	80	<b>Frigorifero a compressore</b> Istruzioni per l'uso

NL	99	<b>Compressorkoelbox</b> Gebruiksaanwijzing
DA	117	<b>Kompressor-køleboks</b> Betjeningsvejledning
SV	134	<b>Kylbox med kompressor</b> Bruksanvisning
NO	150	<b>Kjøleboks med kompressor</b> Bruksanvisning
FI	167	<b>Kompressori-kylmälaatikko</b> Käyttöohje

---

D

Fordern Sie weitere Informationen zur umfangreichen Produktpalette aus dem Hause Dometic WAECO an. Bestellen Sie einfach unsere Kataloge kostenlos und unverbindlich unter der Internetadresse: [www.waeco.de](http://www.waeco.de)

---

GB

We will be happy to provide you with further information about Dometic WAECO products. Please order our free catalogue with no obligation to buy on our homepage: [www.waeco.com](http://www.waeco.com)

---

F

Demandez d'autres informations relatives à la large gamme de produits de la maison Dometic WAECO. Commandez tout simplement notre catalogue gratuitement et sans engagement à l'adresse internet suivante : [www.waeco.com](http://www.waeco.com)

---

E

Solicite más información sobre la amplia gama de productos de la empresa Dometic WAECO. Solicite simplemente nuestros catálogos de forma gratuita y sin compromiso en la dirección de Internet: [www.waeco.com](http://www.waeco.com)

---

I

Per ottenere maggiori informazioni sull'ampia gamma di prodotti Dometic WAECO è possibile ordinare una copia gratuita e non vincolante del nostro Catalogo all'indirizzo Internet: [www.waeco.com](http://www.waeco.com)

---

NL

Maak kennis met het omvangrijke productscala van de firma Dometic WAECO. Bestel onze catalogus gratis en vrijblijvend onder het internetadres: [www.waeco.com](http://www.waeco.com)

---

DK

Bestil yderligere information om det omfattende produktudvalg fra Dometic WAECO. Bestil vores katalog gratis og uforpligtende på internetadressen: [www.waeco.com](http://www.waeco.com)

---

S

Inhämta mer information om den omfattande produktpaletten från Dometic WAECO: Beställ våra kataloger gratis och utan förpliktelser under vår Internetadress: [www.waeco.com](http://www.waeco.com)

---

N

Be om mer informasjon om det rikholdige produktutvalget fra Dometic WAECO. Bestill vår katalog gratis uforbindtlig på Internettadressen: [www.waeco.com](http://www.waeco.com)

---

FIN

Pyytäkää lisää tietoja Dometic WAECO:n kattavista tuotevalikoimista. Tilatkaa tuotekuvastomme maksutta ja sitoumuksetta internet-osoitteesta: [www.waeco.com](http://www.waeco.com)

---

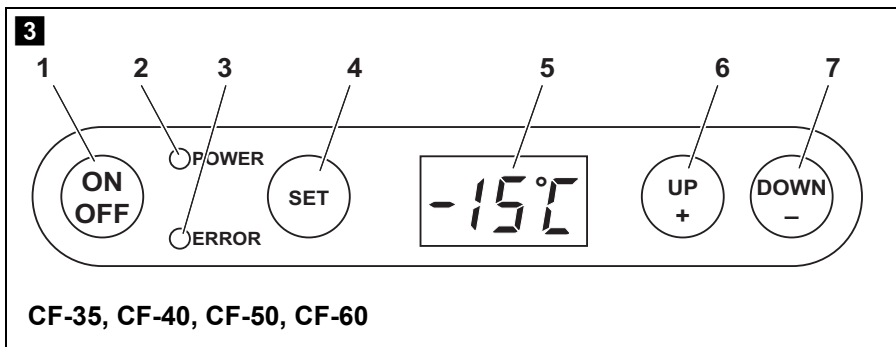
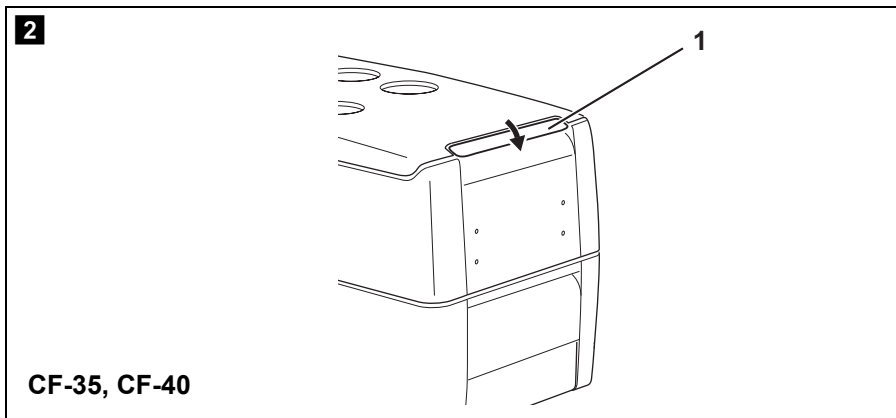
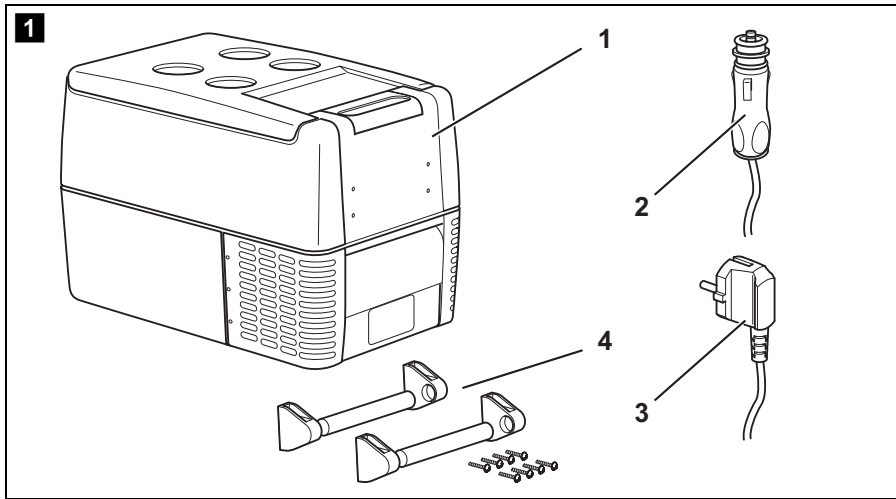

4

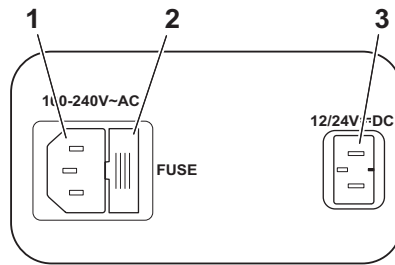

5

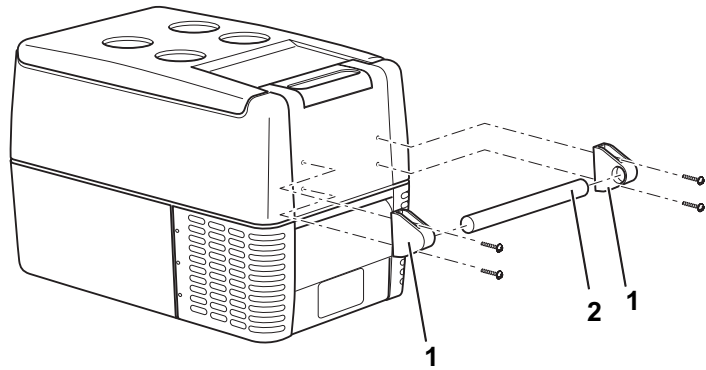

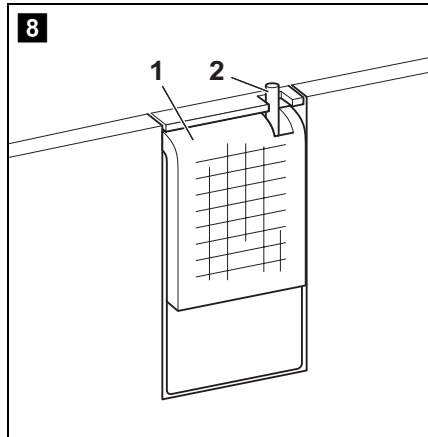
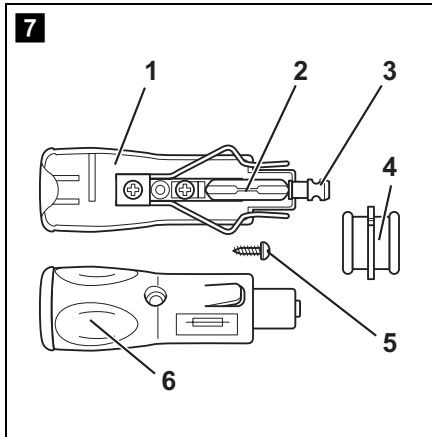
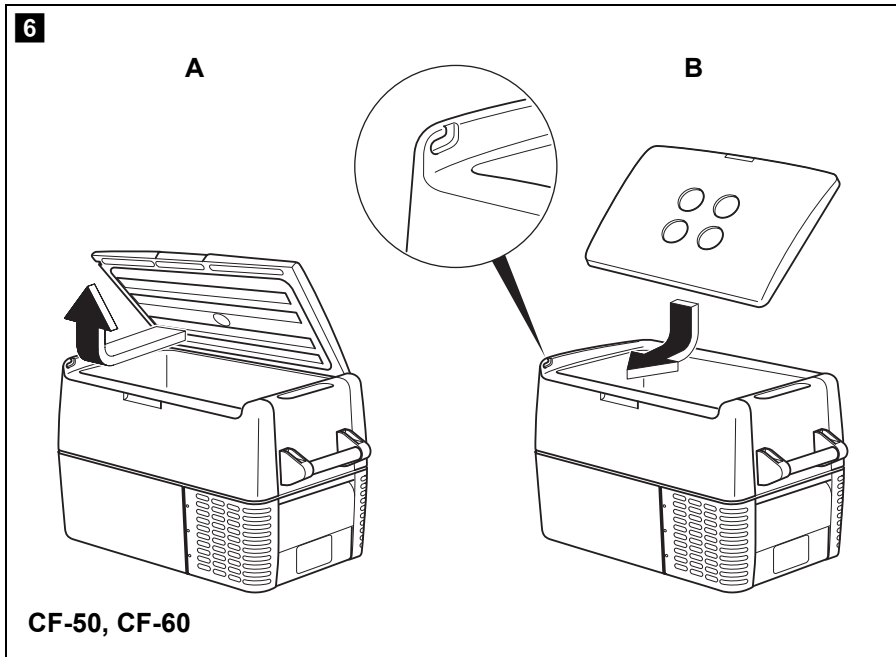

**Please read this operating manual carefully before starting the device. Keep it in a safe place for future reference. If the device is handed over to another person, this operating manual must be handed over along with the device.**

## **Contents**

<b>1</b>	<b>Notes on using the manual</b> .....	26
<b>2</b>	<b>Safety instructions</b> .....	26
2.1	General safety .....	27
2.2	Operating the device safely .....	28
<b>3</b>	<b>Scope of delivery</b> .....	29
<b>4</b>	<b>Intended use</b> .....	29
<b>5</b>	<b>Function description</b> .....	30
5.1	Scope of functions .....	30
5.2	Operating and display elements .....	31
<b>6</b>	<b>Operation</b> .....	32
6.1	Before initial use .....	32
6.2	Energy saving tips .....	33
6.3	Connecting the cooler .....	33
6.4	Using the battery monitor .....	34
6.5	Using the cooler .....	35
6.6	Setting the temperature .....	36
6.7	Switching off the cooler .....	37
6.8	Defrosting the cooler .....	37
6.9	Replacing the device fuse .....	37
6.10	Replacing the plug fuse (12/24 V) .....	38
6.11	Replacing the light bulb .....	38
<b>7</b>	<b>Cleaning and maintenance</b> .....	39
<b>8</b>	<b>Guarantee</b> .....	39
<b>9</b>	<b>Troubleshooting</b> .....	40
<b>10</b>	<b>Disposal</b> .....	40
<b>11</b>	<b>Technical data</b> .....	41

# 1 Notes on using the manual

The following symbols are used in this operating manual:



---

**Caution!**

**Safety instruction:** Failure to observe this instruction can cause material damage and impair the function of the device.

---



---

**Warning!**

**Safety instruction** relating to a danger from an electrical current or voltage. Failure to observe this instruction can cause material damage or personal injury and impair the function of the device.

---



---

**Note**

Supplementary information for operating the device.

---

► **Action:** This symbol indicates that action is required on your part. The required action is described step-by-step.

✓ This symbol describes the result of an action.

**fig. 1 5, page 3:** This refers to an element in an illustration. In this case, item 5 in figure 1 on page 3.

**Please observe the following safety instructions.**

## 2 Safety instructions

The manufacturer will not be held liable for claims for damage resulting from the following:

- Damage to the appliance resulting from mechanical influences and excess voltage
- Alterations to the device without express permission from the manufacturer
- Use for purposes other than those described in the operating manual

## 2.1 General safety



- **Warning – Danger of electrocution!**  
When using the device on boats: If the device is powered by the mains, ensure that the power supply is protected with a ground fault interrupter circuit.
- Check that the voltage specification on the type plate corresponds to that of the energy supply.
- Only connect the device as follows:
  - With the cable supplied (fig. **1** 2, page 3) to the cigarette lighter in the vehicle or to a 12/24 V plug socket in the vehicle
  - or with the enclosed connection cable (fig. **1** 3, page 3) to the 100–240 V AC mains.
- If the connection cable is damaged, it must be replaced by a special cord or assembly available from the manufacturer or service agent.
- Do not pull the plug out of the cigarette lighter or the socket by the cable.
- Pull out the connection cable:
  - Before cleaning and maintenance
  - After use
  - Before changing a fuse
- Disconnect the cooling device and other power consuming devices from the battery before you connect the battery to a quick charging device. Overvoltage can damage the electronics of the device.



- Persons (including children) whose physical, sensory or mental capabilities or lack of experience and knowledge prevents them from using the appliance safely should not use this appliance without initial supervision or instruction by a responsible person.
- **Electronic devices are not toys.**  
Always keep and use the device out of the reach of children.
- Children must be supervised to ensure that they do not play with the device.
- Do not operate the device if it is visibly damaged.
- This device may only be repaired by qualified personnel. Inadequate repairs can lead to considerable hazards.  
Should your device need to be repaired, please contact customer service.

- Do not open the refrigerant circuit under any circumstances!
- The cooler is not suitable for transporting caustic materials or materials containing solvents.
- Food may only be stored in its original packaging or in suitable containers.

## 2.2 Operating the device safely



- **Warning – Danger of electrocution!**  
Do not touch exposed cables with your bare hands. This especially applies when operating the device from an AC mains.
- Before starting the device, ensure that the power supply line and the plug are dry.



- Do not place any electrical devices inside the cooler.
- Set up the device in a dry location where it is protected against splashing water.
- Protect the device and the cable against rain and moisture.
- Do not place the device near naked flames or other heat sources (heaters, direct sunlight, gas ovens etc.)
- **Caution! Danger of overheating!**  
Ensure at all times that there is sufficient ventilation so that the heat generated during normal operation is able to dissipate. Ensure that the ventilation slots are not covered. Make sure that the device is sufficiently far away from walls and other objects so that the air can circulate.
- Never immerse the device in water.
- Do not fill the inner container with ice or fluid.

### 3 Scope of delivery

fig. **1**, page 3, shows the scope of delivery.

Item	Quantity	Description
1	1	Cooler
2	1	Connection cable for 12/24 V $\text{---}$ connection
3	1	Connection cable for 100–240 V $\sim$ connection
4	2	Carrying handle, consisting of: <ul style="list-style-type: none"> <li>– 2 holders</li> <li>– 1 handle</li> <li>– 4 fastening screws</li> </ul>
–	1	Operating manual

### 4 Intended use



The cooler is suitable for cooling and freezing foods. The device is also suitable for use on boats.



The device is designed to be operated from a 12 V $\text{---}$  or 24 V $\text{---}$  on-board supply socket of a vehicle (e. g. cigarette lighter), boat or caravan as well as from a 100–240 V AC mains.



---

#### **Caution – When cooling perishable medicines!**

If you wish to cool medicines, please check if the cooling capacity of the device is adequate for this purpose.

---

## **5 Function description**

The cooler can chill products, keep them cool as well as freeze them. A maintenance-free refrigerant circuit with compressor provides the cooling. The extra strong insulation and powerful compressor ensure especially fast cooling.

The cooler is portable.

When used on boats, the cooler can be withstand a constant heel (inclination) of 30°.

### **5.1 Scope of functions**

- Power supply with priority circuit for connecting to the AC mains
- Three-level battery monitor to protect the vehicle battery
- Turbo mode for rapid cooling
- Display with temperature gauge  
switches off automatically at low battery voltage
- Temperature setting: With two buttons in steps of 1 °C (2 °F)
- Removable carrying handles

## 5.2 Operating and display elements

### CF-35, CF-40

Lock for lid: fig. **2** 1, page 3

### CF-35, CF-40, CF-50, CF-60

Operating panel (fig. **3**, page 3)

Item	Description	Explanation
1	ON OFF	Switches the cooler on or off when the button is pressed for between one and two seconds
2	POWER	Status indication LED lights up green: Compressor is on LED lights up orange: Compressor is off LED flashes orange: display switched off automatically due to low battery voltage
3	ERROR	LED flashes red: Device is switched on but not ready for operation
4	SET	Selects the input mode – Temperature setting – Celsius or Fahrenheit display – Set battery monitor
5	–	Display, shows the information
6	UP +	Press once to increase the value
7	DOWN –	Press once to decrease the value

Connection sockets (fig. **4**, page 4):

Item	Description
1	Connection socket AC voltage supply
2	Fuse holder
3	Connection socket  DC voltage supply

## 6 Operation

### 6.1 Before initial use

**Note**

Before starting your new cooler for the first time, you should clean it inside and outside with a damp cloth for hygienic reasons (please also refer to the chapter “Cleaning and maintenance” on page 39).

#### Mounting the handles

The handles are enclosed unassembled. If you wish to attach the handles, proceed as follows:

- Make a handle by putting two holders (fig. **5** 1, page 4) and a handle (fig. **5** 2, page 4) together.
- Fasten the grip with the enclosed screws in the holes provided.

#### Turning the lid stop around

##### CF-50, CF-60

You can turn the lid stop around if you want to open the lid from the other side. To do this, proceed as follows:

- Open the lid and pull it out (fig. **6** A, page 5).
- Turn the lid.
- Insert the lid in the lid holders on the side opposite the cooler (fig. **6** B, page 5).

#### Selecting the temperature units

You can switch the temperature display between Celsius and Fahrenheit. This is how to do it:

- Switch on the cooler.
- Press the “SET” button (fig. **3** 4, page 3) twice.
- Use the “UP +” (fig. **3** 6, page 3) and “DOWN -” (fig. **3** 7, page 3) buttons to select Celsius or Fahrenheit.
- ✓ The selected temperature units then appear in the display for a few seconds. The display flashes several times before it returns to the current temperature.

## 6.2 Energy saving tips

- Choose a well ventilated installation location which is protected from direct sunlight.
- Allow hot food to cool down first before you place it into the device.
- Do not open the cooler more often than necessary.
- Do not leave the lid open for longer than necessary.
- Defrost the cooler once a layer of ice forms.
- Avoid unnecessary low temperatures.

## 6.3 Connecting the cooler

### Connecting to a battery (Vehicle or boat)

The cooler can be operated with 12 V or 24 V $\text{---}$ .



---

#### **Warning – Danger of damaging the device!**

Disconnect the cooler and other consumer units from the battery before you connect the battery to a quick charging device. Overvoltage can damage the electronics of the device.

---

For safety reasons the cooler is equipped with an electronic system to prevent the polarity reversal. This protects the cooler against short-circuiting when connecting to a battery.

- ▶ Plug the 12/24-V connection cable (fig. **1** 2, page 3) into the DC voltage socket and also into the cigarette lighter or a 12 V or 24 V socket.

### Connecting to a 100–240 V AC mains (E.g. in the home or office)



---

#### **Warning – Danger of electrocution!**

Never handle plugs and switches with wet hands or if you are standing on a wet surface.

---



---

#### **Warning – Danger of electrocution!**

If you are operating your cooler on board a boat from a mains connection of 100–240 V $\sim$ , you must install a residual current circuit breaker between the 100–240 V AC mains and the cooler. Seek advice from a trained technician.

---

The coolers have an integrated multi-voltage power supply with priority circuit for connecting to an AC voltage source of 100–240 V. The priority circuit automatically switches the cooler to mains operation, if the device is connected to a 100–240 V AC mains, even if the 12/24 V connection cable is still attached.

When switching between the AC mains and the battery supply, the red LED may light up briefly.

- ▶ Plug the 100–240 V connection cable (fig. **1** 3, page 3) into the AC voltage socket and connect it to the 100–240 V AC voltage mains.

## 6.4 Using the battery monitor



The device is equipped with a multi-level battery monitor that protects your vehicle battery against excessive discharging when the device is connected to the on-board 12/24 V supply.

If the cooler is operated when the vehicle ignition is switched off, the cooler switches off automatically as soon as the supply voltage falls below a set level. The cooler will switch back on once the battery has been recharged to the restart voltage level.



### Caution – Danger of damage!

When switched off by the battery monitor, the battery will no longer be fully charged. Avoid starting repeatedly or operating current consumers without longer charging phases. Ensure that the battery is recharged.

In “HIGH” mode, the battery monitor responds faster than at the levels “LOW” and “MED” (see the following table).

Battery monitor mode	LOW	MED	HIGH
Switch-off voltage at 12 V	10.1 V	11.4 V	11.8 V
Restart voltage at 12 V	11.1 V	12.2 V	12.6 V
Switch-off voltage at 24 V	21.5 V	24.1 V	24.6 V
Restart voltage at 24 V	23.0 V	25.3 V	26.2 V

This is how to select the battery monitor mode:

- Switch on the cooler.
- Press the “SET” button (fig. **3** 4, page 3) three times.
- Use the “UP +” (fig. **3** 6, page 3) and “DOWN -” (fig. **3** 7, page 3) buttons to select the battery monitor mode.
- ✓ The selected mode then appears in the display for a few seconds. The display flashes several times before it returns to the current temperature.



---

**Note**

When the cooler is supplied by the starter battery, select the battery monitor mode “HIGH”. If the cooler is connected to a supply battery, the battery monitor mode “LOW” will suffice.

If you wish to operate the cooler from the AC mains, set the battery monitor to the “LOW” position.

---

## 6.5 Using the cooler



---

**Caution – Danger of overheating!**

Ensure at all times that there is sufficient ventilation so that the heat that generated during operation can dissipate. Ensure that the ventilation slots are not covered. Make sure that the device is sufficiently far away from walls and other objects so that the air can circulate.

---

- Place the cooler on a firm foundation.  
Make sure that the ventilation slots are not covered and that the heated air can dissipate.
- 



---

**Note**

Place the cooler as shown (fig. **1**, page 3). If you operate the box in a different position it can be damaged.

---

- Close the cooler, see “Connecting the cooler” on page 33.
- 



---

**Note**

If you wish to operate the cooler from the AC mains, set the battery monitor to the “LOW” position.

---

**Caution – Danger from excessively low temperature!**

Ensure that the only those objects are placed in the cooler that are intended to be cooled at the selected temperature.

- Press the “ON/OFF” button (fig. **3** 1, page 3) for between one and two seconds.
- ✓ The “POWER” LED lights up.
- ✓ The display (fig. **3** 5, page 3) switches on and shows the current cooling temperature.

**Note**

The temperature displayed is that of the middle of the interior. The temperatures elsewhere can deviate from this temperature.

- ✓ The cooler starts cooling the interior.

**Note**

When operating with the battery, the display switches off automatically if the battery voltage is low. The LED “POWER” flashes orange.

**Locking the cooler****CF-35, CF-40**

- Close the lid.
- Press the lock (fig. **2** 1, page 3) down, until it latches in place audibly.

**6.6 Setting the temperature**

- Press the “SET” button (fig. **3** 4, page 3) once.
- Use the “UP +” (fig. **3** 6, page 3) and “DOWN -” (fig. **3** 7, page 3) buttons to select the cooling temperature.
- ✓ The cooling temperature appears in the display for a few seconds. The display flashes several times and then the current temperature is displayed again.

## 6.7 Switching off the cooler

- Empty the cooler.
- Switch the cooler off.
- Pull out the connection cable.

If you do not want to use the cooler for a longer period of time:

- Leave the cover slightly open. This prevents odour build-up.

## 6.8 Defrosting the cooler

Humidity can form frost in the interior of the cooling device or on the vaporiser. This reduces the cooling capacity. Defrost the device in good time to avoid this.



---

### Caution – Danger of damaging the device!

Never use hard or pointed tools to remove ice or to loosen objects which have frozen in place.

---

To defrost the cooler, proceed as follows:

- Take out the contents of the cooling device.
- If necessary, place them in another cooling device to keep them cool.
- Switch off the device.
- Leave the cover open.
- Wipe off the defrosted water.

## 6.9 Replacing the device fuse



---

### Warning – Danger of electrocution!

Disconnect the connection cable before you replace the device fuse.

---

- Pull off the connection cable.
- Pry out the fuse insert (fig. 4 2, page 4) with a screwdriver.
- Replace the defective fuse with a new one that has the same rating (T4AL 250V).
- Press the fuse insert back into the housing.

## 6.10 Replacing the plug fuse (12/24 V)

- Pull the adapter sleeve (fig. **7** 4, page 5) off of the plug.
- Unscrew the screw (fig. **7** 5, page 5) out of the upper half of the housing (fig. **7** 1, page 5).
- Carefully raise the upper half of the housing from the lower (fig. **7** 6, page 5) half.
- Take out the contact pin (fig. **7** 3, page 5).
- Replace the defective fuse (fig. **7** 2, page 5) with a new one that has the same rating (8A 32V).
- Re-assemble the plug in the reverse order.

## 6.11 Replacing the light bulb

- Press the switch pin (fig. **8** 2, page 5) downwards so that the transparent part (fig. **8** 1, page 5) of the lamp can be removed at the front.
- Replace the light bulb.



---

### Note

The LEDs in the light bulb must be aligned with the transparent part of the lamp.

---

- Press the transparent part of the lamp back into the housing.

## 7 Cleaning and maintenance



---

**Warning – Danger of electrocution!**

Always pull out the mains plug before you clean and service the device.

---



---

**Caution – Danger of damaging the device!**

Never clean the device under running water or in dish water. Do not use abrasive cleaning agents or hard objects during cleaning as these can damage the device. Never use brushes, scouring pads or hard or pointed tools to remove ice or to loosen objects which have frozen in place.

---

- Occasionally clean the inside of the device with a damp cloth.

## 8 Guarantee

The statutory warranty period applies. If the product is defective, please contact the manufacturer's branch in your country (see the back of the instruction manual for the addresses) or your retailer.

For repair and guarantee processing, please include the following documents when you send in the device:

- A copy of the receipt with purchasing date
- A reason for the claim or description of the fault

## 9 Troubleshooting

Fault	Possible cause	Suggested remedy
Device does not function, LED does not glow.	There is no voltage present in the 12/24 V socket (cigarette lighter) in your vehicle.	The ignition must be switched on in most vehicles to apply current to the cigarette lighter.
	No voltage present in the AC voltage socket.	Try using another plug socket.
	The device fuse is defective.	Replace the device fuse, see "Replacing the device fuse" on page 37.
	The integrated mains adapter is defective.	This can only be repaired by an authorised repair centre.
The device does not cool (plug is inserted, "POWER" LED is lit).	Defective compressor.	This can only be repaired by an authorised customer services unit.
The device does not cool (plug is inserted, "POWER" LED flashes orange, display is switched off).	Battery voltage is too low.	Test the battery and charge it as needed.
When operating from the 12/24-V socket (cigarette lighter): The ignition is on and the device is not working and the LED is not lit.	The cigarette lighter socket is dirty. This results in a poor electrical contact.	If the plug of your cooler becomes very warm in the cigarette lighter socket, either the lighter socket must be cleaned or the plug has not been assembled correctly.
	The fuse of the 12/24 V plug has blown.	Replace the fuse (8 A) in the 12/24 V plug, see "Replacing the plug fuse (12/24 V)" on page 38.
Pull the plug out of the socket and make the following checks.	The vehicle fuse has blown.	Replace the vehicle's 12/24 V socket fuse (usually 15 A). Please refer to your vehicle's operating manual.
The display shows an error message (e.g. "Err1") and the appliance does not cool.	The appliance has switched off due to an internal fault.	This can only be repaired by an authorised repair centre.

## 10 Disposal

- Place the packaging material in the appropriate recycling waste bins wherever possible.



If you wish to finally dispose of the device, ask your local recycling centre or specialist dealer for details about how to do this in accordance with the applicable disposal regulations.

## 11 Technical data

	CF-35	CF-40
Overall capacity:	31 litres	37 litres
Connection voltage:	12/24 V $\equiv$ and 100–240 V $\sim$	
Rated current:		
– 12 V $\equiv$ :	6.0 A	6.0 A
– 24 V $\equiv$ :	3.0 A	3.0 A
– 100–240 V $\sim$ :	1.3 to 0.7 A	1.3 to 0.7 A
Cooling capacity:	+10 °C to –18 °C (+50 °F to 0 °F)	
Dimensions (W x H x D) in mm:	580 x 385 x 360	580 x 445 x 360
Weight:	15 kg	16 kg

	CF-50	CF-60
Overall capacity:	49 litres	59 litres
Connection voltage:	12/24 V $\equiv$ and 100–240 V $\sim$	
Rated current:		
– 12 V $\equiv$ :	7.0 A	7.0 A
– 24 V $\equiv$ :	3.0 A	3.0 A
– 100–240 V $\sim$ :	1.3 to 0.7 A	1.3 to 0.7 A
Cooling capacity:	+10 °C to –18 °C (+50 °F to 0 °F)	
Dimensions (W x H x D) in mm:	630 x 480 x 360	630 x 582 x 360
Weight:	18 kg	21.6 kg



### Note

If the ambient temperature is above +32°C (+90 °F), the minimum temperature cannot be attained.

Test/certificates:



Versions, technical modifications and delivery options reserved.  
The coolant circuit contains R134a.